

# RE : PUBLIC LANDSCAPE

IFLA WORLD CONGRESS 2022

AUG. 09, 2021

IFLA World Congress 2022 Organizing Committee

## contents

- Overview
- Theme
- About Gwangju
- Schedule
- Keynote Speakers
- Venue
- Technical Visits and Post-Congress Tour
- Organizing Committee
- BI logo and Main Poster
- Teaser Homepage
- Appendix

## Overview

**Title** : IFLA WORLD CONGRESS, GWANGJU 2022

**Organizer** : IFLA (International Federation of Landscape Architects)

IFLA World Congress 2022 Organizing Committee

**Date** : 2022. 8. 28. (SUN) ~ 9. 3. (SAT), 7days

**Venue** : Kimdaejung Convention Center

**Homepage** : [www.ifla2022korea.com](http://www.ifla2022korea.com)

## Theme



- The world has witnessed rapid changes with reactions to the spread of the pandemic, a technological revolution, and political conflicts. In 2022, as professionals, we are entrusted to provide visions for a healthy, happy, and beautiful world and, therefore, will gather to discuss issues of landscape from a global to local scale.
- We will have discussions and events to reclaim the public leadership of landscape architecture by **re:visiting** the professional and academic practices to date, **re:shaping** the earth through emerging discourse and technologies, **re:living** everyday lives in healthier and more vibrant ways, and finally **re:connecting** back to nature.

**We invite you to Gwangju, Korea, to share collective ideas and visions for a better future.**

Theme

# RE:PUBLIC LANDSCAPE

Discussions and events on four sub-themes  
to get back **public leadership** of landscape



RE:VISIT

- History and theory of modern landscape architecture
- Critical review of contemporary landscape architecture and urbanism
- Public leadership of the landscape architect as professionals



RE:SHAPE

- Resilient design
- Climate-sensitive landscape design and planning
- Smart city and landscape architecture



RE:VIVE

- Millennials and the creative class that pay attention to locals
- New urban lifestyles and everyday aesthetics
- Post-Covid19 (new normal era) and landscape architecture for health



RE:CONNECT

- Relationship between the city and nature
- Cultural diversity and social inclusiveness
- Adaptation to pandemic urbanism



# About Gwangju

Seoul - Gwangju (about 300km)

- 3.5 hrs by bus
- 2 hrs by train

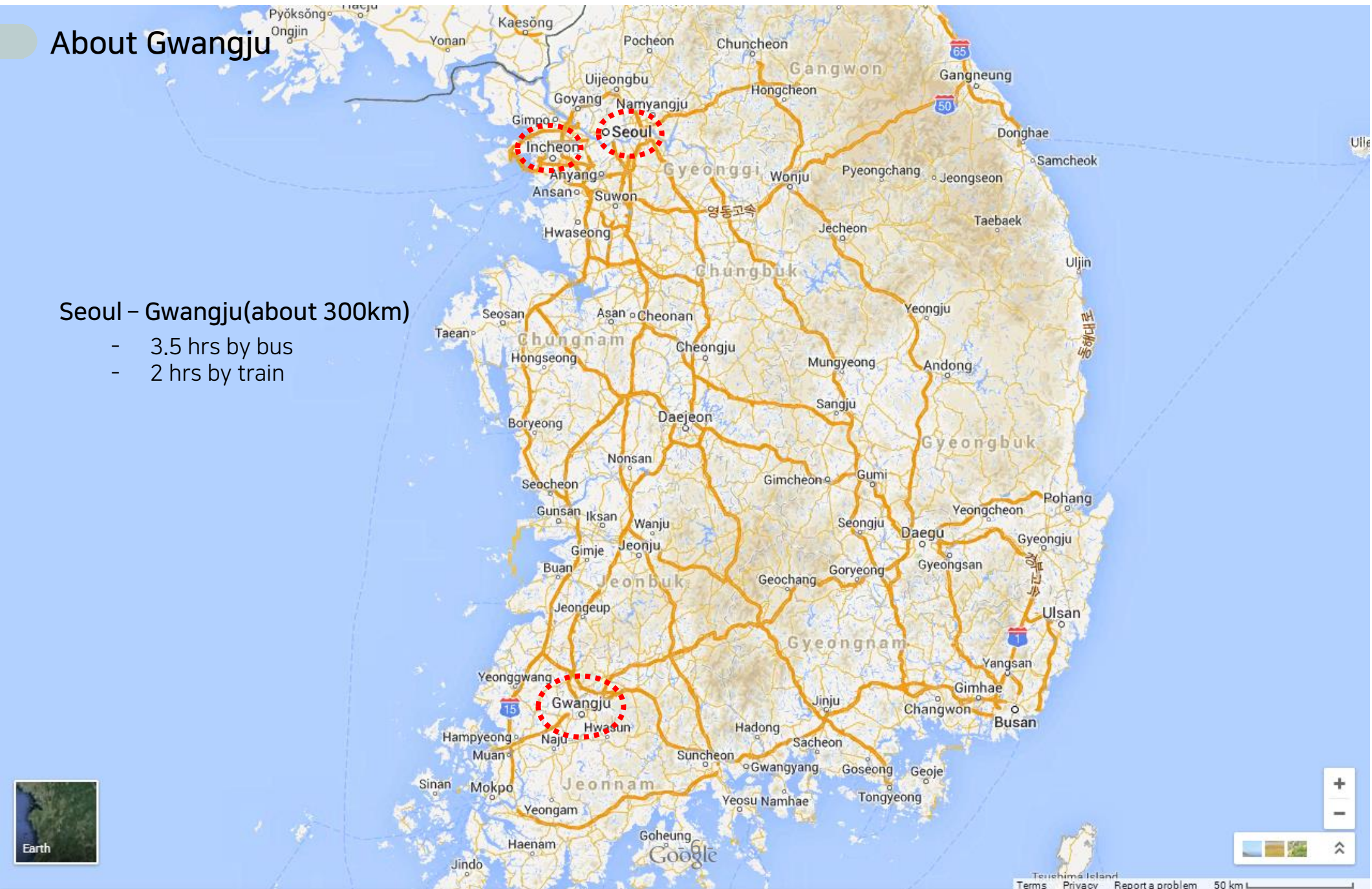

## Sacred Land of Democratization, Righteous City, GWANGJU

The May 18 Democratic Movement, which protested against the tyranny of the military regime, had a profound impact on democratization movements in Asian nations craving freedom and justice from dictatorships. The Records of the May 18 Democratic Movement were listed in the UNESCO Memory of the World Register on May 25, 2011, and are recognized for their world historical value. In May 2020, May 18 was designated as a local public holiday to mark the 40th anniversary of the Democratic Movement.



## Hub of Asian Cultures and Global Arts, Elegant City, GWANGJU

Gwangju has been reborn as a cultural capital of Korea and a cultural hub of Asia, hosting the Gwangju Biennale and Design Biennale, a world-class festival in the field of contemporary art and design. The Asia Cultural Center opened in November 2015, and the nation's longest project (2003-2023) is underway to firmly establish Gwangju as an Asian cultural hub. The city also hosted the Universiade Gwangju 2015, which was a low-cost, high-efficiency event and a cultural festival with youths from around the world.

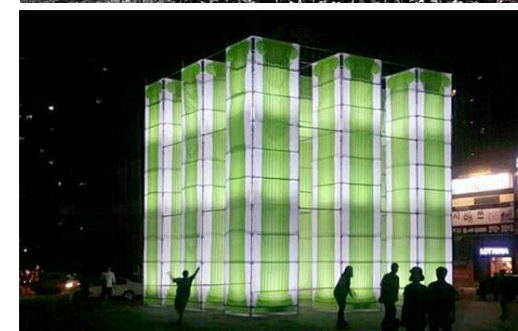

## Habitat of Ecological and Geological Wonders, Nature City, GWANGJU

Mudeungsan Mountain is the symbol of Gwangju as the mountain containing the spirit of the Namdo people. The pale pink azaleas and rhododendrons are in full bloom in spring, the autumn leaves and silver grass on the ridges in the autumn, and the legends of the winter mountain add to the spirit and the scenery of Mudeungsan. Bingwoldang is the name of the auditorium of Wolbong Seowon. The Hwangryong River is a good environment for birds, so herons and egrets come to form a colony of protected birds. In particular, the wet fog of the Hwangryong River is beautiful with a mysterious atmosphere.



## Region of Traditional Gardens, Heritage City, GWANGJU

A traditional garden in Korea has diverse cultural, historical values, such as the then phases of the times, life phase, culture and art, etc. because it was developed on the basis of the harmony between nature and artificial structures. Gwangju is the origin of the Korean garden from the Joseon period and Soswaewon Garden is a private garden where the beauty of traditional Korea is preserved. Soswaewon Garden presents itself as a clean and transparent garden where the righteous enjoy the life surrounded by a bamboo grove.

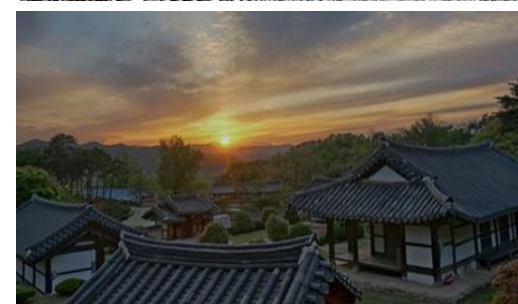

## Schedule

Pre-Congress (SEOUL)				Main-Congress (GWANGJU)		
Day 1	Day 2	Day 3	Day 4	Day 5	Day 6	Day 7
Sun., AUG. 28	Mon., AUG. 29	Tue., AUG. 30	Wed., AUG. 31	Thu., SEP. 1	Fri., SEP. 2	Sat., SEP. 3
-IFLA World EXCO meeting	-IFLA World Council meeting	-IFLA World Council meeting (move to Gwangju)	-Opening Ceremony -Plenary Session -Opening Reception	-Plenary Session -Sub Session	-Plenary Session -Technical Visits -Closing Ceremony + Gala Dinner + IFLA-APR Award	-Post Congress Tour
-International Student Charrette (Gwangju)	-International Student Charrette (Gwangju)	-International Student Charrette -International Student Competition Jury (Gwangju)				

### 1. Meetings and Lectures

IFLA World EXCO meeting, IFLA World Council meeting, Plenary Session, Sub Session

### 2. Program for Students

International Student Charrette, International Student Competition and Award

### 3. Events & Technical Tours

Opening Ceremony, Opening Reception, Geoffrey Jellicoe Award, Gala Dinner, Technical Visits, Post Congress Tour

### 4. Etc.

Garden Expo, Exhibition, IFLA-APR Award



## Keynote Speakers - DAY 1



**Henri Bava**  
Agence TER

- President of the French Landscape Association
- Professor at Landscape at KIT Institute of Technology
- President of the board of directors of the ENSNP
- Invited Professor of Harvard GSD
- Notable Works: Grand Parc des Docks de Saint-Ouen, Parc de la canopia urbana, etc.



**Jeong, Keun-sik**  
Seoul National University

- Ph.D. in Sociology, Seoul National University
- Vice President of the Institute of Korean Studies, Kyujanggak, Seoul National University
- Director of Seoul National University Institute for Unification and Peace
- Author of Endless Challenges for Peace



**Kim, Ah-yeon**  
University of Seoul,  
Studios Terra

- Bachelor and Master's degree of Landscape Architecture at Seoul National University
- Master of Landscape Architecture at University of Virginia
- Chair of Programme Committee, IFLA 2022
- Participant for the Venice Biennale of Architecture 2021

## Keynote Speakers - DAY 2



**Daan Roosegaarde**  
Studio Roosegaarde

- Master of Architecture in Berlahe Institute
- Invited Professor at Monterey University, Mexico
- Design Singapore Council Advisor
- 2016 the London Design Innovation medal
- Notable Works: Smog Free Project, Waterlicht, Sustainable Dance Floor, etc.



**Moon, Gyeong-won**  
Ewha Women's University

- Master's degree at the University of California Arts Graduate School
- The Snow Art Award for the Gwangju Biennale
- National Museum of Contemporary Art, Artist of the Year Award
- Designer of the Korean Pavilion at the Venice Biennale



**Lee, Man-ui**  
Korea Greenhouse Gas Reduction Recycling Association

- Ph.D. in Public Administration of Seoul National Univ. and Dongguk Univ.
- Former Vice mayor of Gwangju
- Former Minister of Environment
- President of organizing committee of Suncheonman International Garden Expo

## Keynote Speakers - DAY 3



**Kim, Jung-yoon**

Harvard GSD,  
Office Parkkim

- Bachelor of Science in Landscape architecture, Seoul National University
- Master of Landscape Architecture Harvard University GSD
- Selected the next generation of design leaders



**Jillian Walliss**

University of Melbourne

- Master degree in Landscape Architecture at the University of Melbourne
- Universitas 21 Fellowship
- Edward Brown Award
- Co-author of The Big Asian Book of LA
- Co-author of Digital Technologies and LA



**Heike Rahmann**

RMIT University

- Ph.D. in Department of Architecture, Tokyo University
- AILA VIC LA Award
- MSD Teaching Excellence Award
- Co-author of The Big Asian Book of LA
- Co-author of Digital Technologies and LA



**Dong Zhang**

Co-president of Z+T Studio

- Master degree in Landscape Architecture, Chongqing University and University of Massachusetts
- Turnscape, EDSA Orient Work
- 2014 ASLA AWARD
- 2017 ASLA AWARD



**Ziyang Tang**

Co-president of Z+T Studio

- Master of Urban Planning and Environmental Design, Peking University
- Master of Landscape Architecture, University of Massachusetts
- SSA to work for Martha Schwartz
- 2014 ASLA AWARD
- 2017 ASLA AWARD

## Venue for IFLA EXCO & World Council

- THE PLAZA Seoul, Autograph Collection Hotels
- Location : 119 SOGONG-RO, JUNG-GU, SEOUL, KOREA (04525)
- For IFLA EXCO : Oak Room (4F)
- For IFLA World Council : Diamond Hall (22F), Maple Hall (4F)



## Venue for IFLA World Congress 2022

### Kimdaejung Convention Center (KDJ Convention Center)

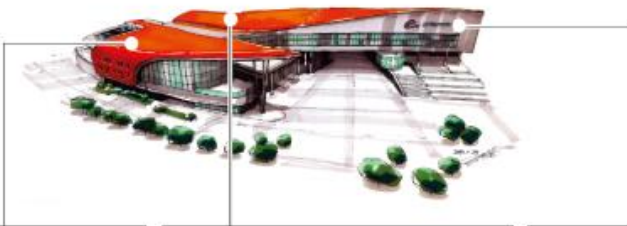

4F		컨벤션홀1~3   방송실   VIP실	4F
3F	회의실301~307   방송실   대기실   컨퍼런스홀	회의실C308~C312   VIP실 주최자사무실   방송실	3F
2F	회의실201~214   방송실   통역실   미디어코   컨퍼런스홀	주최자사무실   방송실   VIP실   비즈니스센터   연회사무실	2F
1F	다목적홀   VIP실   열람실   출판자미디어실   주최자사무실 대기실	1전시장   2전시장   3전시장   포코스홀   주최자사무실	1F
B1	지하주차장	지하주차장	B1

- **Venue:** Kimdaejung Convention Center
- **Location:** 30, Sangmunuri-ro, Seo-gu, Gwangju, Korea
- **Space:** 53,301m<sup>2</sup>
- **Facility Introduction**
  - 1F: Multipurpose Hall, Exhibition Hall
  - 2,3F: Conference Hall
  - 4F: Convention Hall
  - Parking Lot: 1,502

## Venue - KDJ Convention Center



Lobby



Convention Hall

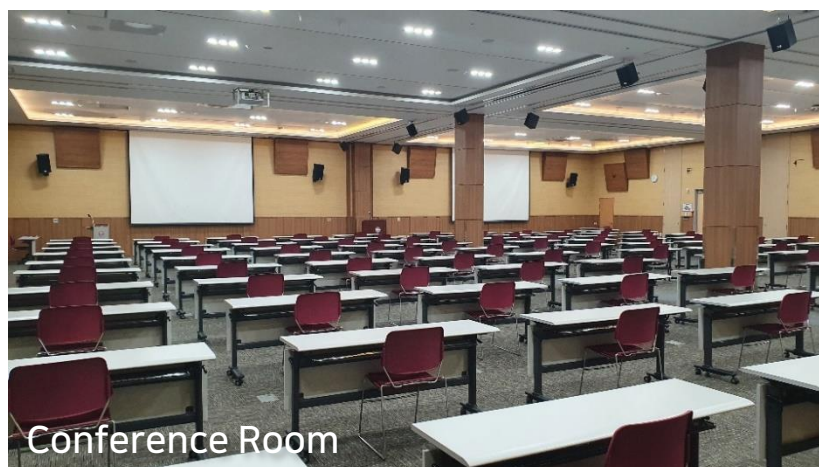

Conference Room



Multipurpose Hall

## Technical Visits and Post-congress Tour

### DAY 1 & DAY 2\_ Walk & Talk



**Yangnim-dong**  
(Local Culture)



**Asia Culture Center**  
(History of Democracy)



**Gwangju Greenways**  
(Green Governance)

+ **Gwangju City Arboretum** (expected for completion in May 2022)

## Technical Visits and Post-congress Tour

### DAY 3\_ Technical Visits

#### ① Gwangju

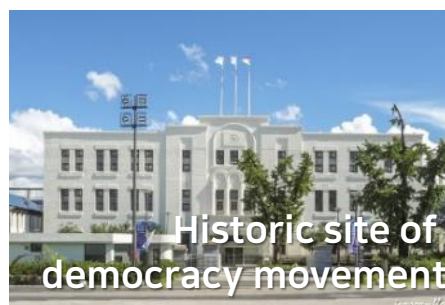



## Technical Visits and Post-congress Tour

### DAY 3\_ Technical Visits

#### ② Damyang

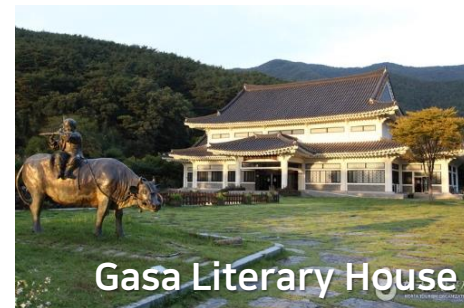

## Technical Visits and Post-congress Tour

### DAY 4\_ Post-congress Tour

#### ① Mokpo



#### ② Suncheon



#### ③ Sinan



#### ④ Hwasun



#### ⑤ Yeosu



#### ⑥ Haenam



#### ⑦ Gangjin



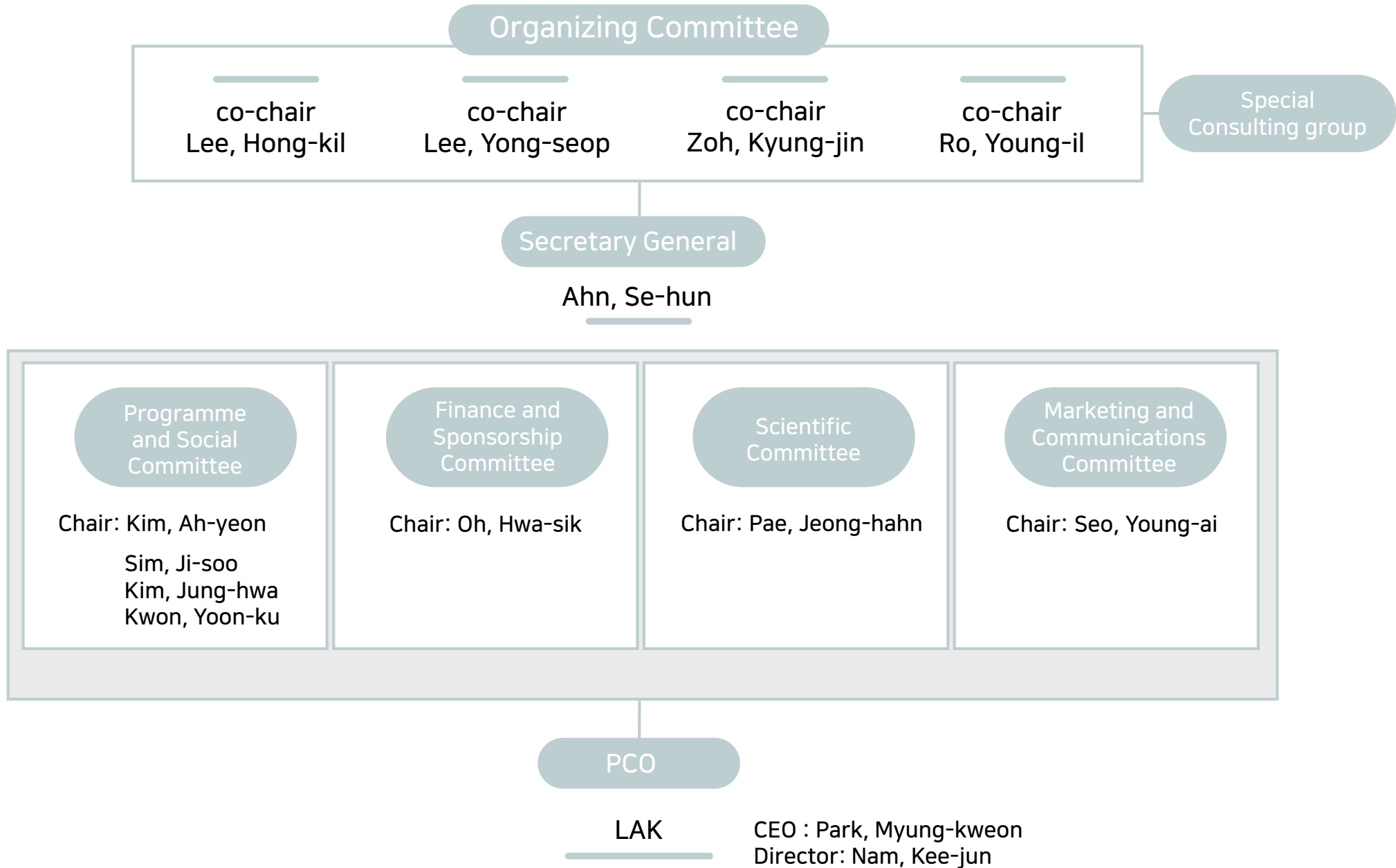

## BI logo



- ✓ This BI logo means that the expanded dot form in RE:PUBLIC, the theme of the IFLA World Congress 2022, meets with the color symbolizing the venue (Gwangju) and connects and changes into various sub-themes.



**RE : PUBLIC**  
LANDSCAPE  
IFLA WORLD CONGRESS 2022



**RE : PUBLIC**  
LANDSCAPE  
IFLA WORLD CONGRESS 2022



**RE : PUBLIC**  
LANDSCAPE  
IFLA WORLD CONGRESS 2022



**RE : PUBLIC**  
LANDSCAPE  
IFLA WORLD CONGRESS 2022



**RE : PUBLIC**  
LANDSCAPE  
IFLA WORLD CONGRESS 2022



**RE : PUBLIC**  
LANDSCAPE  
IFLA WORLD CONGRESS 2022

Main Poster



**IFLA WORLD CONGRESS  
GWANGJU 2022**



The world has witnessed rapid changes with reactions to the spread of the pandemic, a technological revolution, and political conflicts. In 2022, as professionals, we are entrusted to provide visions for a healthy, happy, and beautiful world and, therefore, will gather to discuss issues of landscape from a global to local scale.

**31 AUG - 2 SEPT, 2022  
Gwangju, Korea**

[www.ifla2022korea.com](http://www.ifla2022korea.com)  
#ifla2022







**IFLA WORLD CONGRESS  
GWANGJU 2022**



The world has witnessed rapid changes with reactions to the spread of the pandemic, a technological revolution, and political conflicts. In 2022, as professionals, we are entrusted to provide visions for a healthy, happy, and beautiful world and, therefore, will gather to discuss issues of landscape from a global to local scale.

**31 AUG - 2 SEPT, 2022  
Gwangju, Korea**

[www.ifla2022korea.com](http://www.ifla2022korea.com)  
#ifla2022







Teaser Homepage www.ifla2022korea.com

D-387



IFLA WORLD CONGRESS, GWANGJU 2022

RE:PUBLIC LANDSCAPE

AUG 31 - STEP 2, 2022 Gwangju, Korea

Date : AUG. 31 SEP. 2, 2022 Venue : Gwangju, Korea Theme : RE:PUBLIC LANDSCAPE

We invite you to Gwangju, Korea, to share collective ideas and visions for a better future.



RE:PUBLIC LANDSCAPE

The world has witnessed rapid changes with reaction to the spread of the pandemic, a technological revolution, and political conflicts. In 2022, as professionals, we are entrusted to provide visions for a healthy, happy, and beautiful world and, therefore, will gather to discuss issues of landscape from a global to local scale. We will have discussions and events to reclaim the public leadership of landscape architecture by revisiting the professional and academic practices to date, reshaping the earth through emerging discourse and technologies, reviving everyday lives in healthier and more vibrant ways, and finally reconnecting back to nature.

RE:VISIT

- History and theory of modern landscape architecture
Critical review of contemporary landscape architecture and urbanism
Public leadership of the landscape architect as professional

RE:VIVE

- Millennials and the creative class that pay attention to locals
New urban lifestyles and everyday aesthetics
Public leadership of the landscape architect as professional

RE:SHAPE

- Resilient design
Climate sensitive landscape design and planning
Smart city and landscape architecture

RE:CONNECT

- Relationship between the city and nature
Cultural diversity and social inclusiveness
Adaptation to pandemic urbanism

About Gwangju



Sacred Land of Democratization, Righteous City, Gwangju

The May 18 Democratic Movement, which protested against the tyranny of the military regime,

# Appendix

Floor Guidance

- KDJ Convention Center



## Floor Guidance - KDJ Convention Center

### Multipurpose Hall – 1F

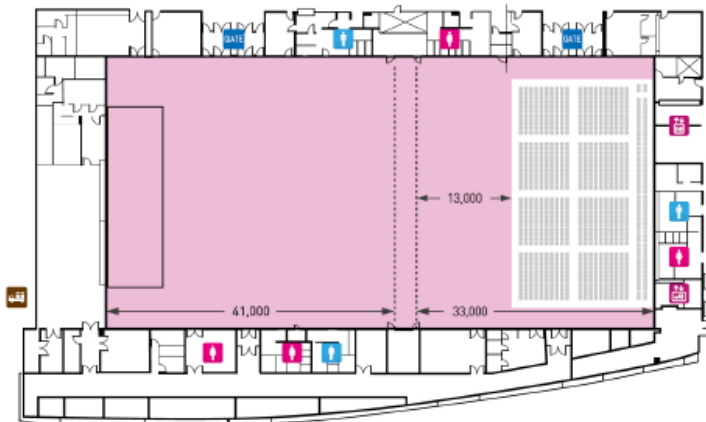

- **Space:** 2,955m<sup>2</sup>  
(stage – 8mx24mx0.9m)
- **Capacity**  
- 3,000 Seats
- **Major Facilities**  
- Organizer’s office, Performers Waiting Room, VIP Rooms, Simultaneous Interpretation Booths in 8 languages

Category	Space (m <sup>2</sup> )	Capacity (maximum number of people)	
		Theater	Class
1 Hall	1,478	1,200	800
2 Hall	1,478	1,100	500
1+2 Halls	2,955	3,000	1,300

## Floor Guidance - KDJ Convention Center

### Exhibition Hall - 1F

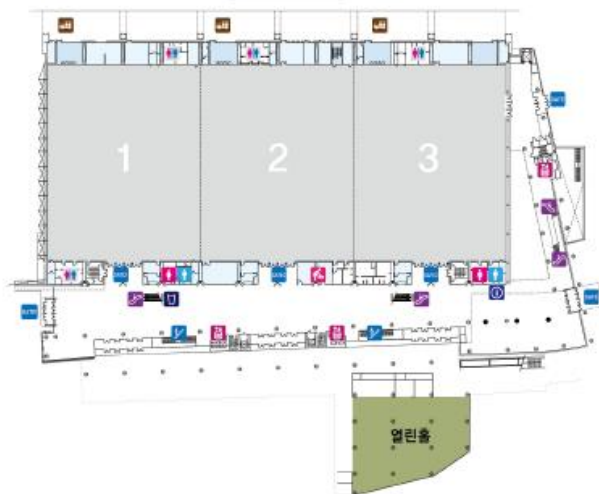

- **Space** : 9,072m<sup>2</sup>
- **Capacity** : 500 booths, 3x3(m)

Category	Space (m <sup>2</sup> )
Exhibition Hall1	3,024
Exhibition Hall2	3,024
Exhibition Hall3	3,024
Open Hall	1,000
Concourse Hall	2,500
Outdoor Stage	263.84
Outdoor Square	1,322

## Floor Guidance - KDJ Convention Center

### Conference Rooms – 2F

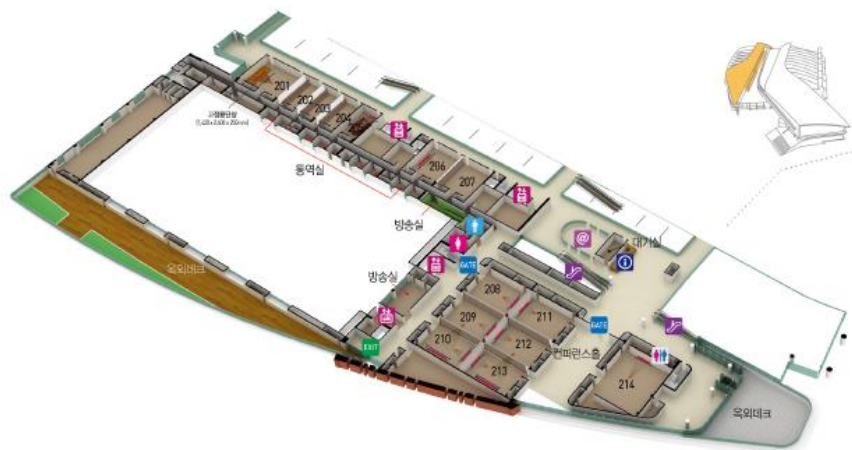

- **Space:** 1,157m<sup>2</sup>
- **Capacity**
  - Class: 30~200seats
  - Theater: 40~300seats
- **Major Facilities**
  - 14 Conference Rooms
  - Conference Hall, Waiting Room, Business Center, Outdoor Deck, Business Lounge, VIP Room

Room No.	Space (m <sup>2</sup> )	Capacity (maximum number of people)	
		Theater	Class
201 / 202+203 / 203+204	108	72	48
202~203	54	40	30
205	54	14	14
206 / 207	81	60	40
201+202 / 206+207 / 202+203+204	162	144	96
201+202+203	216	200	144
201+202+203+204	270	300	200
208~213	88	72	48
208+209 / 209+210 / 211+212 / 212+213	176	160	100
208+209+210 / 211+212+213	264	240	160
214	143	128	80
208+209+210+211+212+213	552	448	300

## Floor Guidance - KDJ Convention Center

### Conference Rooms – 3F

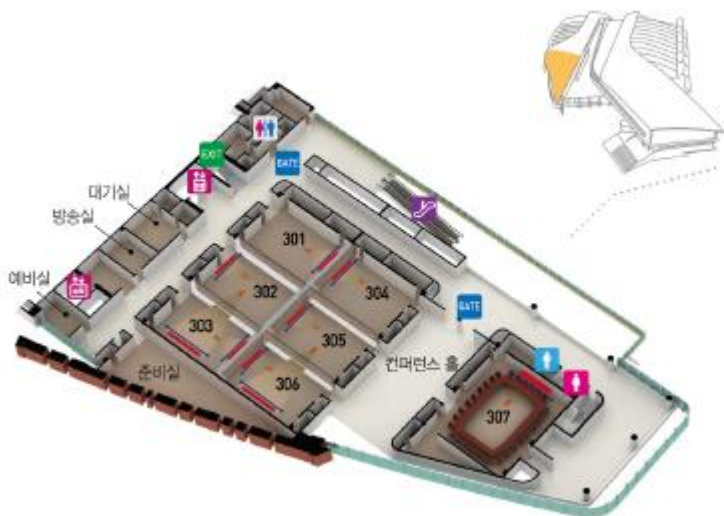

- **Space:** 671m<sup>2</sup>
- **Capacity**
  - Class: 48~300seats
  - Theater: 75~450seats
- **Major Facilities**
  - 7 Conference Rooms
  - Conference Hall, Waiting Room, Business Center, Outdoor Deck, Business Lounge

Room No.	Space (m <sup>2</sup> )	Capacity (maximum number of people)	
		Theater	Class
301~306	88	72	48
301+302 / 302+303 / 304+305 / 305+306	176	176	160
301+302+303 / 304+305+306	264	264	240
307	143	28	28
301+302+303+305+306	552	448	330

## Floor Guidance - KDJ Convention Center

### Conference Rooms – 3F, Convention



- **Space:** 519m<sup>2</sup>
- **Capacity**
  - Class: 40~170seats
  - Theater: 72~230seats
- **Major Facilities**
  - 5 Conference Rooms
  - Organizer's Office, Preparation Room, Board Rooms, Recess Lounge, VIP Room, Conference Hall

Room No.	Space (m <sup>2</sup> )	Capacity (maximum number of people)	
		Theater	Class
C308~C310	155	72	50
C311 / C312	87	72	40
C308+C309 / C309+C310	230	150	100
C311+C312	174	144	96
C308+C309+C310	345	230	170

## Floor Guidance - KDJ Convention Center

### Convention Hall – 4F

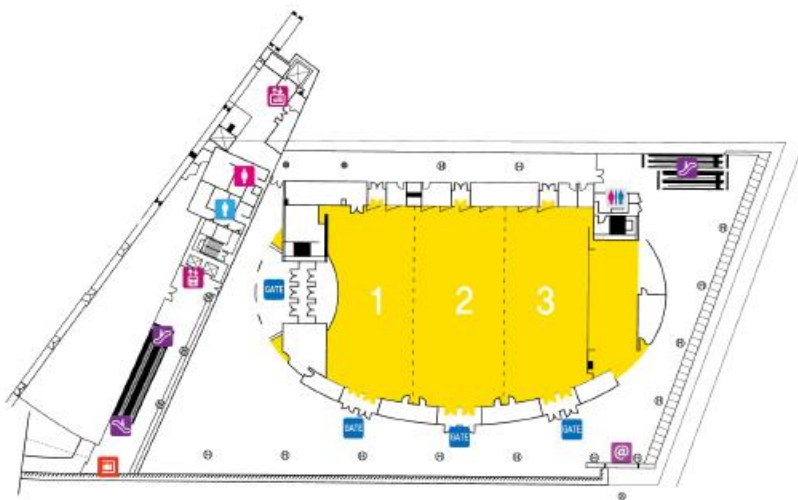

- **Space:** 1,518m<sup>2</sup>
- **Capacity**
  - Class: 150~850seats
  - Theater: 300~1,200seats
- **Major Facilities**
  - Organizer's Office, Preparation Room, Board Rooms, Recess Lounge, VIP Room, Conference Hall

Category	Space (m <sup>2</sup> )	Capacity (maximum number of people)	
		Theater	Class
Hall 1	506	300	200
Hall 2	506	300	200
Hall 3	506	192	169
Hall 1+2 / Hall 2+3	1,012	600	450
Hall 1+2+3	1,518	1,200	750

Thank you.